



College of Design

Architecture

Undergraduate Information

The Study of Architecture

Architecture is a cultural phenomenon arising from the aspirations that individuals and groups have for their quality of life and the environment that supports it, and from the social enterprise of designing and building for the future. It involves individual and multiple buildings, the spaces within them, and the exterior landscape. Knowledge of architectural design, technology and theory are brought together at Iowa State University in the study of architecture as a cultural discipline, encompassing diverse peoples, values and needs for the world we inhabit.



Monica Kim demonstrates her team's "thinking cap" motion machine, ARCH 202



IOWA STATE UNIVERSITY

Find us online at
www.design.iastate.edu/ARCH

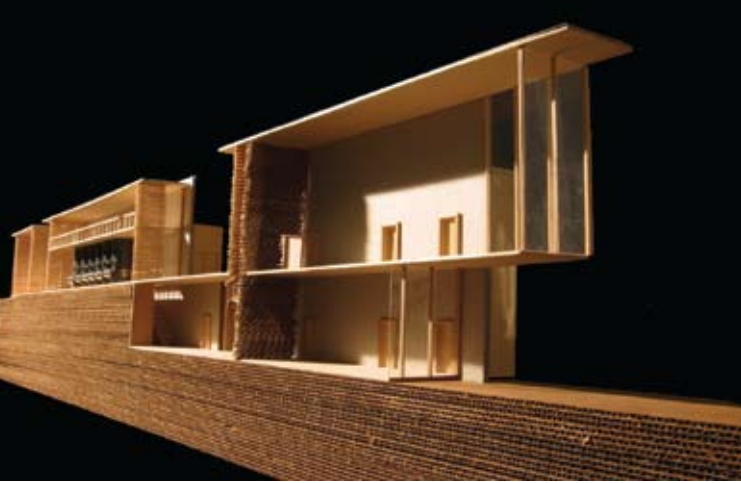

David Wagner, digital visualization collage, ARCH 230



Site model, ARCH 201

How do we design energy-efficient homes and offices that make use of renewable energy sources?

In what ways do buildings, gardens and public spaces add beauty to our lives?

Architecture at Iowa State University

The Iowa State University department of architecture is a comprehensive center for teaching, research and public service in architecture. Located in Ames, Iowa, the university enjoys the charm of a small town as well as the rich and complex urbanity of its neighbor, Des Moines. Architecture courses were first offered at Iowa State in the 1870s. Today, the department offers the only accredited, professional architecture degrees in the state of Iowa.



Zach Brown and George Schaub demonstrate their team's "leapfrog" motion machine, ARCH 202

The department of architecture is part of the College of Design and, together with the departments of art and design, landscape architecture, and community and regional planning, forms a unique and innovative interdisciplinary environment. At all levels, the department is committed to the study of architecture as a cultural discipline in which issues of practice, of the social and environmental context in which buildings exist, and of environmental effects are combined with the subject matter of building design—construction, space, material, form and use.

The Degree

Iowa State's department of architecture offers a five-year, bachelor of architecture professional degree accredited by the National Architectural Accrediting Board. The department also offers an accredited master of architecture degree and a post-professional graduate degree.



Campo dei Fiori, Rome, Italy



Summer study abroad in China

Christine Fruehling, experiential mapping exercise, ARCH 230



Andrew Long, floor plan and digitally manipulated images, New York City loft project, ARCH 302

Can cities and towns be designed, instead of just "happening"?

The Curriculum

The undergraduate curriculum is both an intense professional course of study and a broadly conceived experience in general education. The curriculum is composed of a one-year pre-professional program—known as the Core Design Program—followed by a professional program that is typically four years in length. The first-year curriculum includes courses in design, drawing and cultural studies. Courses in math and science are required, as well as general studies in the humanities and social sciences.

At the end of the pre-professional year, admission to the professional program is based upon performance in the Core Program, the applicant's previous school record, portfolio and essay evaluations, and available departmental resources. The department of architecture annually admits 68 students into the professional program.

The professional curriculum follows a sequence of increasingly advanced involvement in the aspects of the field of architecture: design; technology; history, theory and criticism; human behavior; and design communication.

The design studio is a fundamental element of the undergraduate architecture program. From the beginning, students are involved in the construction, representation and simulation of architecture. Extensive use is made not only of the design studio, but also the wood shop, various computer laboratories and advanced rapid prototyping equipment. In addition to completing classroom projects, students regularly visit such cities as Chicago, Minneapolis, New York, Los Angeles and Montreal. The average studio size is 16 students, offering the opportunity for close contact with faculty members.

The fifth year is dedicated to student work with design processes, research, and value development. Elective studios are offered both semesters, during which each student has the opportunity to select a faculty member to work with to examine the processes and values at an advanced level. Students also may engage in a project exploring the design possibilities within an area of personal interest.

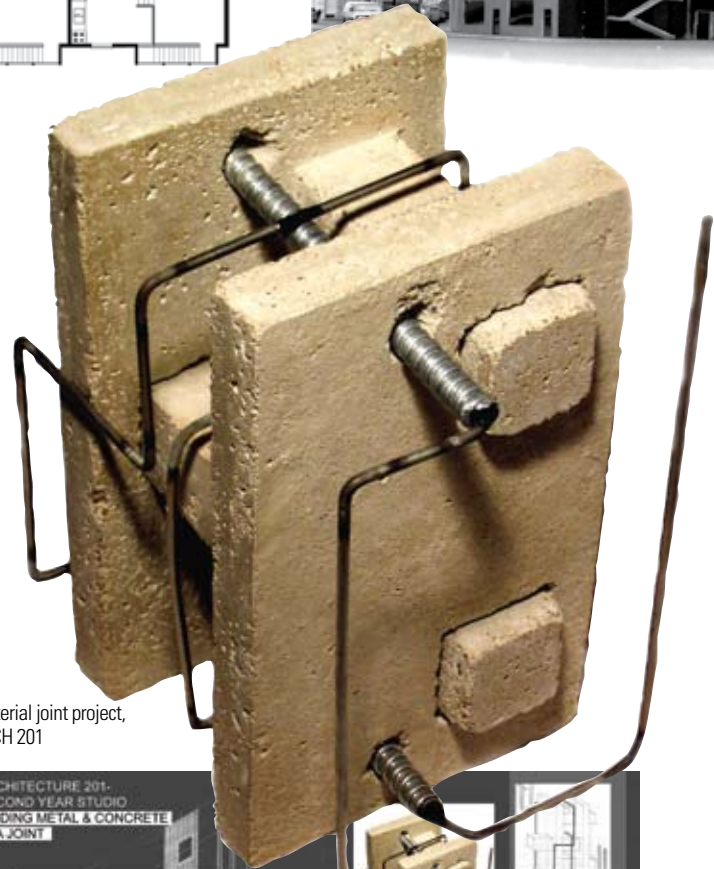

Material joint project, ARCH 201



Pantheon, Rome, Italy

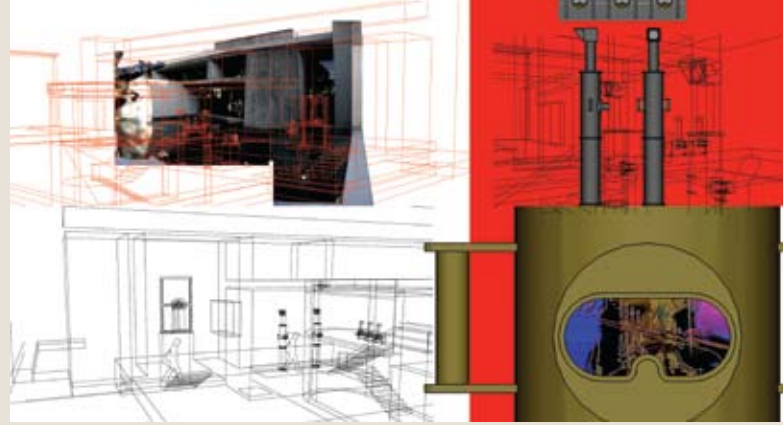

Jeremy Perreault, digital visualization collage, ARCH 230

Why do ancient structures mean so much to us even today?

Opportunities and Resources

The department conducts a semester-long program for fourth-year students in Rome. Participants engage in a design studio and in seminars that emphasize the unique culture and environment of Italy and Western Europe. Other international studies in places like China and South America are available through special summer courses and university exchange programs.

Students can pursue their research interests in a variety of venues, including an interdisciplinary outreach service of the College of Design in which students and faculty of various departments work jointly on projects that address opportunities for community and urban development in Iowa. They can also network with practicing professionals and learn about professional life through department-sponsored workshops. Departmental lectures regularly feature nationally and internationally known speakers.

If these questions interest you, consider a major in architecture.

Other on-campus activities help students develop intellectually and professionally. Through the Iowa State chapter of the American Institute of Architecture Students (AIAS), students can join their peers at local social events and at national symposia all across the country. Architecture students can use their writing and photographic skills by contributing to *Core*, the department's student journal. Students may also participate in the university honors program, which offers seminars, special programs and projects for undergraduates who have demonstrated the ability and motivation to assume more than the usual responsibility for their undergraduate education.

The College of Design's Career Services Office conducts workshops, publishes notices of job openings, and schedules interviews for graduating students. An architecture faculty member serves as an intern adviser for those students seeking jobs in the profession while they are in school.

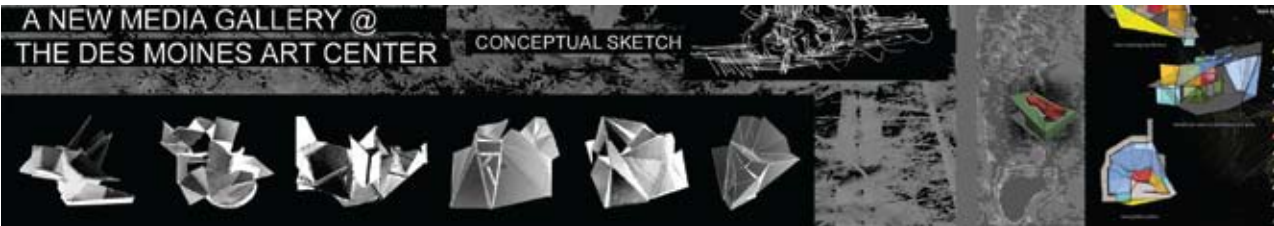

Brad Baer, proposal board, new media gallery project, ARCH 201

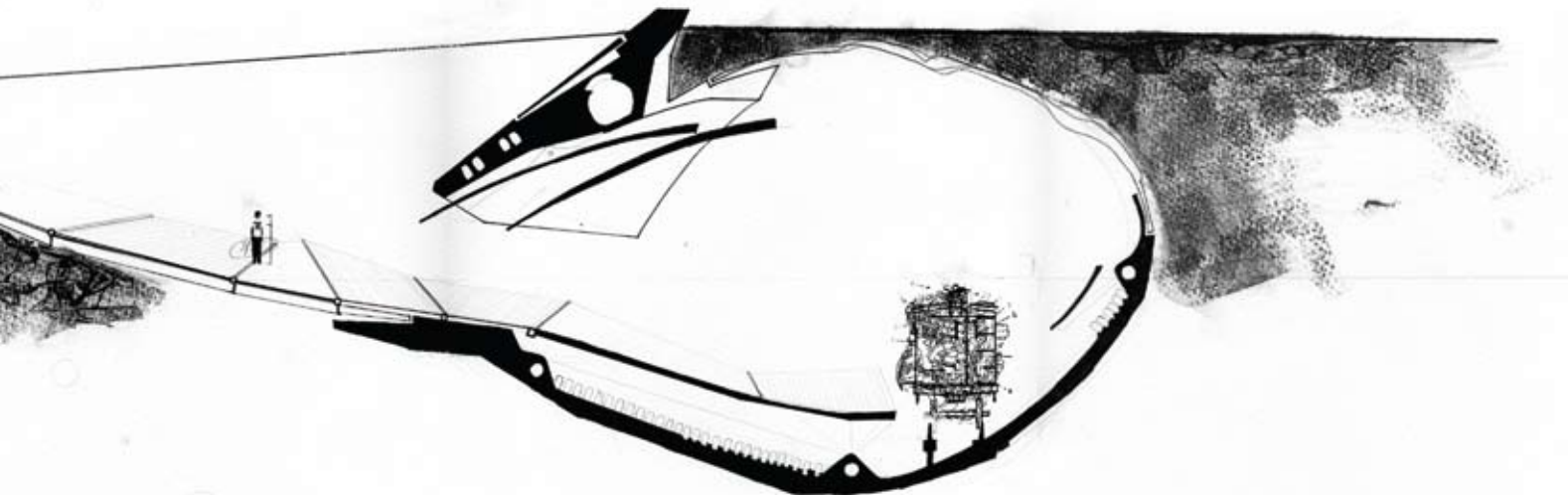



Phil Kolbo, Rich Luckritz, Bob Perry and Chris Schoo, concepts for a lunar colony, lunar architecture project, ARCH 528



Ashley Alexandres, Tony Camarena, Gabriel Gallaher and Tonia Sorenson, lunar architecture digital lighting project, ARCH 528



Tonia Sorenson and Kristin Jensen, model, Montreal Mediatheque project, ARCH 401

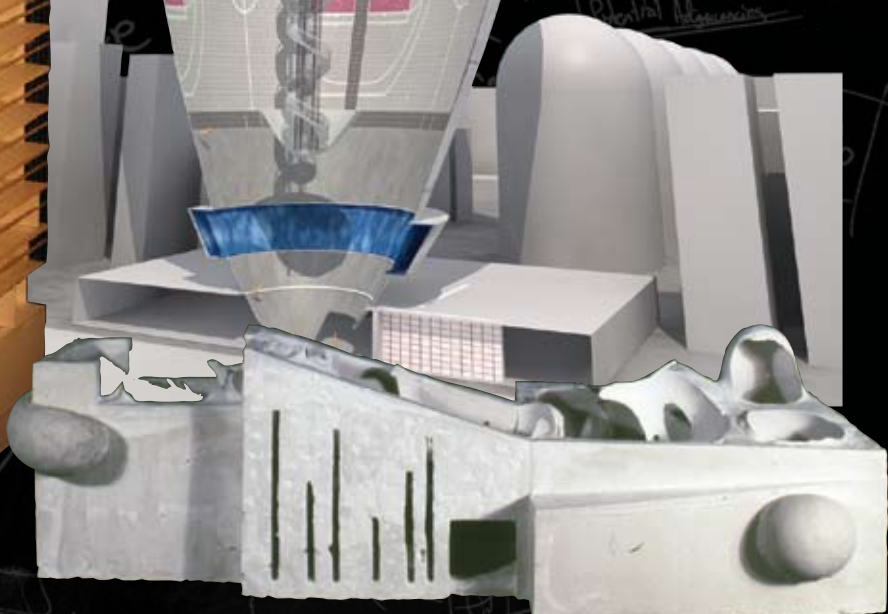

Alisa Christiansen, plaster gallery models, ARCH 201

Dustin Harford, digital visualization collage, ARCH 230



The Facilities

The College of Design, home to the department of architecture, features five stories of studio classrooms and offices wrapped around a public atrium capped with a vaulted skylight. Outside are expansive lawns, native prairie plantings, and several display areas for public art. Inside are the gallery, Design Reading Room, model shop, Design Café, art supply store, output center, Digital Acquisition Lab, and several computer labs.

The computer graphics lab allows students to concentrate on image editing, three-dimensional modeling, and animation. The model shop is a fully equipped fabrication facility, including a CNC router. Advanced rapid prototyping equipment, such as laser cutters and a 3-D printer, also is available.



Demand for Graduates

Architects forge successful careers in a wide variety of professional settings. While the majority of Iowa State architecture graduates work in private architectural firms, some pursue creative opportunities as filmmakers, environmental designers, technical writers and artists. Others put their problem-solving skills to work as real-estate developers, museum curators, historical preservationists, and public-policy leaders. In the past several years, all Iowa State architecture graduates have found employment in the field or continued their education within six months of graduation.



ADA ramp construction, post-Hurricane Katrina outreach studio, DSN S 446/546



Students visit Bourbon Street in the French Quarter, New Orleans

Iowa State University does not discriminate on the basis of race, color, age, religion, national origin, sexual orientation, gender identity, sex, marital status, disability, or status as a US veteran. Inquiries may be directed to the Director of Equal Opportunity and Diversity, 3680 Beardshear Hall, Ames, IA 50011-2024, (515) 294-7612.

High School Preparation

Beyond the minimum requirements for admission to Iowa State University, students who plan to enter the architecture program are encouraged, but not required, to take at least one semester each of trigonometry and analytic geometry, one year of physics, and studio art classes.

Financial Assistance

The university offers financial assistance in the form of grants, scholarships, loans and part-time employment. Scholarship recipients generally are selected on the basis of academic merit or other demonstrated talent as well as financial need. The College of Design awards one scholarship to entering students in design-related disciplines, and the department offers 27 scholarships and awards for students in the professional program.

Contact Us

To learn more about earning a degree in architecture, contact the department or the Office of Admissions:

Iowa State University
Department of Architecture
156 College of Design
Ames, IA 50011-3093
(515) 294-4717
www.design.iastate.edu/ARCH

Office of Admissions
Iowa State University
Enrollment Services Center
Ames, IA 50011-2010
(800) 262-3810
admissions@iastate.edu
www.admissions.iastate.edu

